

Open Space  
Area:  
3,103,000 Sq. Ft.  
71.235 Acres

Open Space  
Area:  
3,103,000 Sq. Ft.  
71.235 Acres

Open Space  
Area:  
3,103,000 Sq. Ft.  
71.235 Acres

PHASE III

PHASE III

Lot #31  
Street # 659  
Area:  
136,244 Sq. Ft.  
3.128 Acres

Lot #30  
Street # 657  
Area:  
161,729 Sq. Ft.  
3.713 Acres

N/f  
Amston Lake Company

N/f  
Wolfgang Schmitt  
&  
Lori Halla

N/f  
Charles L.  
&  
Elaine M.  
Wallace

N/f  
Michael A.  
&  
Cheryl E.  
Chinigo

N/f  
Daniel A.  
&  
Lorri A.  
Duchesneau

N/f  
Joseph  
&  
Christine Est.  
Burba

N/f  
Catherine  
Poulin

N/f  
NRLL East LLC

N/f  
Nancy B. Mussman  
Trustee

N/f  
Reja Acquistion

Church Street aka  
Conn. Route #85

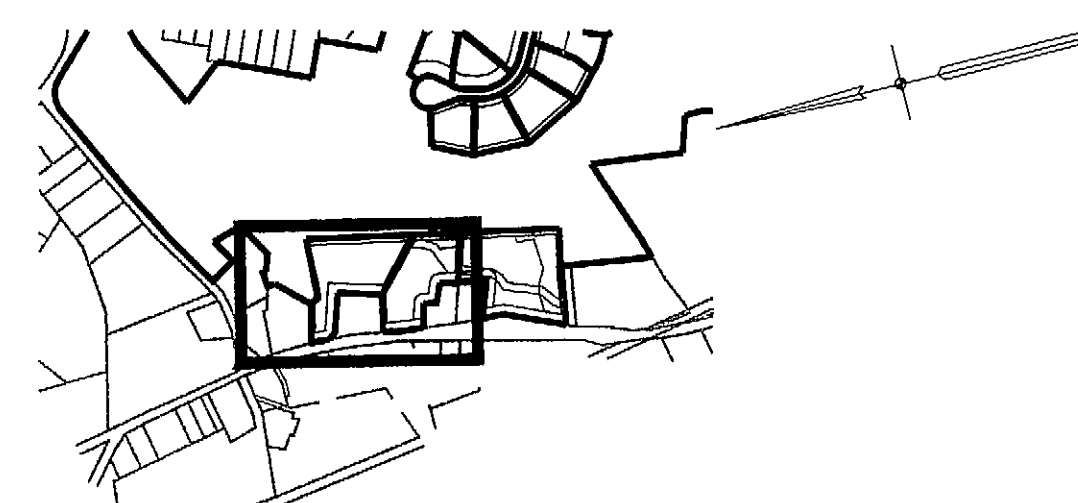
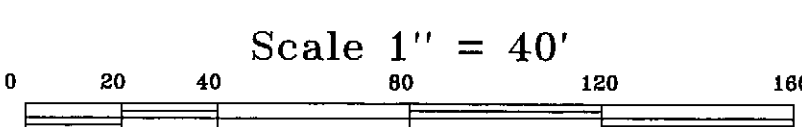

Sheet Index Map  
1" = 1,000'

All Lots Containing Stone Walls  
To Have 5' Conservation Easements  
Along Said Walls

NOTE: THIS SURVEY AND MAP HAS BEEN PREPARED IN ACCORDANCE WITH SECTIONS 20-300b-1 THRU 20-300b-20 OF THE REGULATIONS OF CONNECTICUT STATE AGENCIES - "MINIMUM STANDARDS FOR SURVEYS AND MAPS IN THE STATE OF CONNECTICUT" AS ENDORSED BY THE CONNECTICUT ASSOCIATION OF LAND SURVEYORS, INC. IT IS A SUBDIVISION SURVEY BASED ON A DEPENDENT RESURVEY, CONFORMING TO HORIZONTAL ACCURACY CLASS "A-2", VERTICAL ACCURACY CLASS "T-3" AND INTENDED TO BE USED FOR SUBDIVISION APPROVAL.

TO MY KNOWLEDGE AND BELIEF, THIS MAP IS SUBSTANTIALLY CORRECT AS NOTED HEREON.  
MICHAEL L. TARBELL L.S. 15466 12-03-07  
REGISTRATION NO. DATE

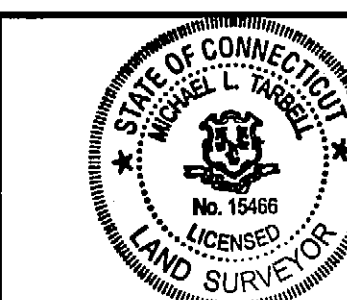

See Sheet #7 For Legend

"LAKEWOOD ESTATES"

RECORD SUBDIVISION MAP

PREPARED FOR  
**JAMES GROSSMAN**  
LAKE ROAD, HILLCREST DRIVE, & RTE #85  
HEBRON, CONNECTICUT

**TARBELL, HEINTZ & ASSOC., INC.**  
CIVIL ENGINEERS - LAND SURVEYORS

1227 BURNSIDE AVE. SUITE 31, EAST HARTFORD, CT (860) 528-1810

JOB NO.	DATE	SCALE	DRAWN BY	SHEET NO.
1091	12-03-07	1" = 40'	M.L.T./E.M.W.	12 OF 39

THIS MAP PRODUCED BY ORIGINAL INK DRAWING ON POLY FILM  
TARBELL, HEINTZ & ASSOC.,  
1227 BURNSIDE AVE., SUITE 31  
EAST HARTFORD CT 06108