

See Sheet #31
See Sheet #30
Lot #21

For Grades
Exceeding 3:1
See Note On
Page 3.

N/f
Rhonda
Ostrager
Trustee

Open
Space

Lot #20

Open
Space

Lot #19

N/f
Steven P.
Norige

See Sheet #30
See Sheet #29

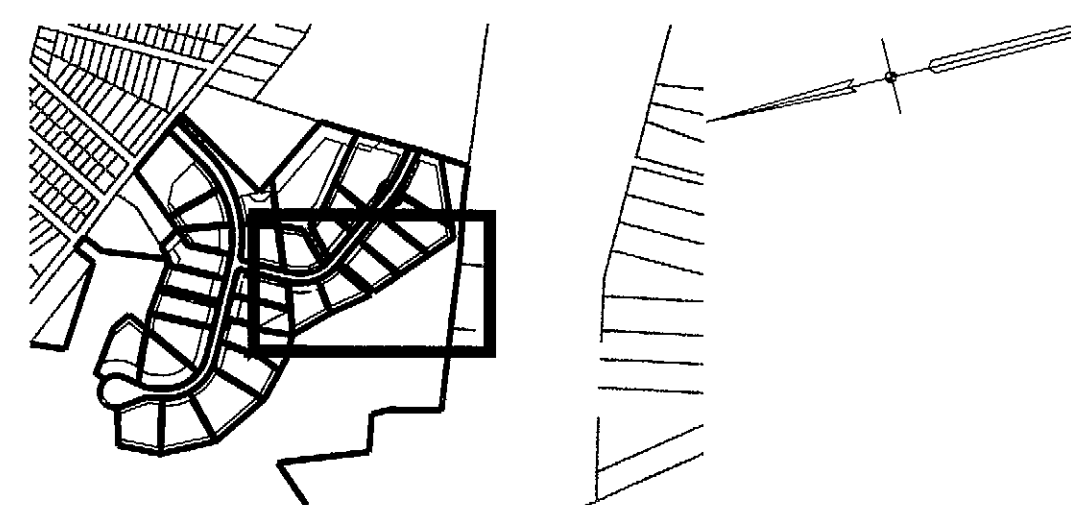
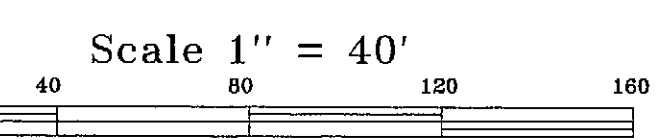

See Sheet #3 For Legend

THIS MAP PRODUCED BY
ORIGINAL INK DRAWING ON
POLY FILM
TARBELL, HEINTZ & ASSOC.
1227 BURNSIDE AVE., SUITE 31
EAST HARTFORD CT 06108

NOTE: THIS SURVEY AND MAP HAS BEEN PREPARED IN ACCORDANCE WITH SECTIONS 20-300b-1 THRU 20-300b-20 OF THE REGULATIONS OF CONNECTICUT STATE AGENCIES - "MINIMUM STANDARDS FOR SURVEYS AND MAPS IN THE STATE OF CONNECTICUT" AS ENDORSED BY THE CONNECTICUT ASSOCIATION OF LAND SURVEYORS, INC. IT IS A SUBDIVISION SURVEY BASED ON A DEPENDENT RESURVEY, CONFORMING TO HORIZONTAL ACCURACY CLASS "A-2" - VERTICAL ACCURACY CLASS "1-3" AND INTENDED TO BE USED FOR SUBDIVISION APPROVAL.

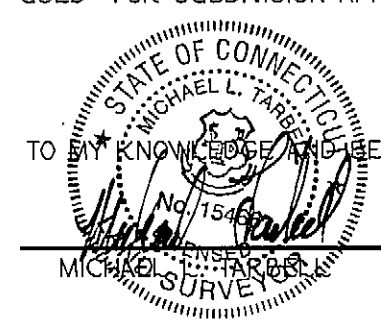

L.S. 15466
REGISTRATION NO.
12-03-07
DATE

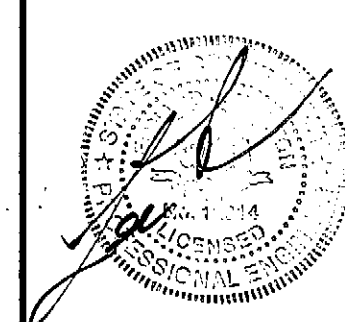

REVISION
5-12-10
9-14-10
10-12-10

"LAKEWOOD ESTATES"
STORM WATER MANAGEMENT PLAN
PREPARED FOR
JAMES GROSSMAN
LAKE ROAD, HILLCREST DRIVE, & RTE #85
HEBRON, CONNECTICUT

TARBELL, HEINTZ & ASSOC., INC.
CIVIL ENGINEERS - LAND SURVEYORS
1227 BURNSIDE AVE. SUITE 31, EAST HARTFORD, CT (860) 526-1810

JOB NO. 1091	DATE: 12-03-07	SCALE: 1" = 40'	DRAWN BY: M.L.T./E.M.W.	SHEET NO.: 30 OF 39
-----------------	-------------------	--------------------	----------------------------	------------------------